

E90L Series - Lined 90° Elbow

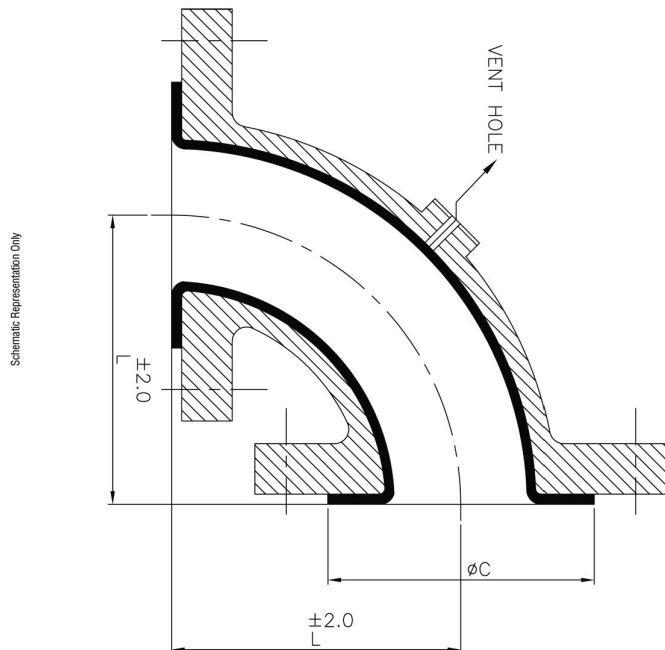

Housing Material Options :

- Ductile Iron GGG40.3 / ASTM A395
- Cast Steel ASTM A216 Gr.WCB
- Steel Fabrication – ASTM A234 Gr.WPB with Flanges are as per ASTM A105 / IS 2062.

* Rotating Flange is also available on request.

Lining Material Options :

- TEFLON® PTFE – ASTM D 4895
- TEFLON® FEP – ASTM D 2116
- TEFLON® PFA – ASTM D 3307
- PVDF – ASTM D 3322
- POLYPROPYLENE – ASTM D 4101
- HDPE

Dimensional Data :

ANSI #150 Flanged		
SIZE	L (mm)	∅C (mm)
DN15-1/2"	65	35
DN20-3/4"	75	43
DN25-1"	89	51
DN40-1 1/2"	102	73
DN50-2"	114	92
DN65-2 1/2"	127	105
DN80-3"	140	127
DN100-4"	165	157
DN150-6"	203	216
DN200-8"	229	270
DN250-10"	279	323
DN300-12"	305	381

Technical Specifications :

- Flange : As per ANSI B16.5 / B 16.42
- Face to Face : As per ANSI B 16.5 #150
- Lining Thickness : 3 to 5 mm
- Other Flange Drillings like, DIN 2632 / 2633, BS 10 Table D, E or F are also available on request.

Test & Inspection Data :

Resins are confirming to the requirements of ASTM F1545-97 (2003)

- Hydraulic Test : 29 Kg/Cm² After Lining.
- Spark Test : 15 KV D.C After Lining.

Technical Information subject to change without notice



How to Order - E90L Series

How to Order:

Series	Material					Features					
Number	Body	Trim	Body & Trim Liner	Seats	Ends	Class	Size	Operation			
E90L	2 WCB	NONE	P PTFE	NONE	F FLANGED RF	0 ANSI 150#	01 1"	NONE			
	3 A312 TP 304		V PVDF				01.25 1-1/4"				
	4 ASTM A395		L PPL				01.5 1-1/2"				
			W HDPE				02 2"				
			A PFA				02.5 2-1/2"				
			F FEP				03 3"				
							04 4"				
							06 6"				
							08 8"				
							10 10"				
							12 12"				

Lined 90° Elbow, Body WCB+ PFA Liner, Flanged RF ANSI Class 150# Size 6"

E90L-2A-F006

