

7LS Series - Wafer Type Lined Swing Check Valve

Schematic Representation Only

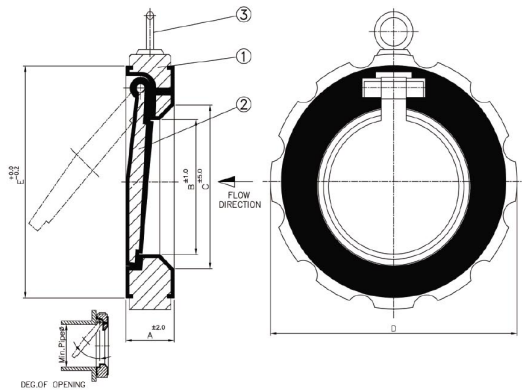

| No. | Description | Moc |
|-----|------------------|---|
| 1 | Body With Lining | Ductile Iron GGG40.3 / ASTM A216 Gr.WCB (FEP Lined) † (FEP Lined) † |
| 2 | Lined Disc | Ductile Iron GGG40.3 (FEP Lined) † |
| 3 | Eye Bolt | C.S (Zinc Plated) |

† Standard Scope of Supply

Special Installation Instruction :

Use PTFE Retainer Ring if connecting pipe ID is greater than Max. Inner Pipe Ø mentioned in below table. In such case retainer ring ID shall be equal to max. pipe ID required for respective size.

Body Material Options :

- Ductile Iron GGG40.3 / ASTM A395
- Cast Steel ASTM A216 Gr.WCB
- ASTM A351 Gr. CF8 / S.S.304
- ASTM A351 Gr. CF8M / S.S.316

Lining Material Options :

- TEFLON® PFA – ASTM D 3307
- TEFLON® FEP – ASTM D 2116
- TEFZEL® (ETFE) – ASTM D 3159
- KYNAR® (PVDF) – ASTM D 3322

Technical Specifications :

- Design Standard : BS EN 593:2004 (Formerly BS 5155)
- Flange : As per ANSI B16.5 / B16.42
- Face to Face : ANSI B16.10 / DIN 3202 K1 / BS 5155 / ISO 5752 / API 609 / BS EN 558 – 1&2
- Lining Thickness : 3 to 5 mm
- Testing Standard : BS EN 12266-1&2 (2003)

Dimensional Data :

| SUITABLE TO MOUNT BETWEEN ANSI #150 FLANGES | | | | | | | | |
|---|------------|-----------|-----------|-----------|-----------|--------------|------|-----------------|
| SIZE | A† (mm) | B (mm) | C (mm) | D (mm) | E (mm) | Inner Pipe Ø | | Max. Opening |
| | | | | | | Min. | Max. | |
| DN40-1 1/2" | 33 | 20 | 35 | 95 | 70 | 35 | 46 | 52° |
| DN50-2" | 43 | 30 | 52 | 110 | 90 | 46 | 56 | 52° |
| DN80-3" | 46 | 42 | 64 | 142 | 124 | 73 | 82 | 52° |
| DN100-4" | 52 | 65 | 80 | 180 | 152 | 95 | 100 | 60° |
| DN150-6" | 56 | 111 | 128 | 233 | 207 | 145 | 150 | 60° |
| DN200-8" | 60 | 133 | 175 | 295 | 260 | 192 | 195 | 60° |
| DN250-10" | 68 | 184 | 224 | 348 | 317 | 242 | 260 | 52° |
| DN300-12" | 78 | 232 | 272 | 398 | 367 | 292 | 310 | 52° |
| DN350-14" | 92 | 252 | 297 | 426 | 397 | 315 | 330 | 48° |
| DN400-16" | 102 | 327 | 370 | 510 | 470 | 380 | 390 | 45° |

† As per BS EN558-2, Table-5, Series-20

Testing in accordance with BS EN 12266-1 (2003) Table A.3

Salient Features :

- Ideal Replacement to costly high alloy valves.
- No Spring or Pin – No Corrosion or Wear & Tear
- Low Pressure Drop
- Special Liner Locking System to hold liner securely in position.

Test & Inspection Data :

- Hydraulic Test # : Body - 15 Kg/Cm2
Back Seat - 2 Kg/Cm2

| ΔP (psi) | Leakage Rate |
|------------|---------------|
| 0 – 40 | 5 – 10 cc/min |
| 41 – 74 | 3 – 5 cc/min |
| 75 & Above | 0 cc/min |

- Spark Test : 15 K.V. D.C Spark Test

Optional Design/Components :

- PTFE SOLID RETAINER RING

Technical Information subject to change without notice



How to Order - 7LS Series

How to Order:

| Series | Material | | | | | Features | | | | | | |
|--------|-----------|---------|-------------------|-------|---------|-------------|--------------|-----------|--|--|--|--|
| Number | Body | Disc | Body & Trim Liner | Seats | Ends | Class | Size | Operation | | | | |
| 7LS | 2 WCB | 2 WCB | A PFA | NONE | W WAFER | 0 ANSI 150# | 0.5 1/2" | NONE | | | | |
| | 3 CF8M | 3 316SS | F FEP | | | | 0.75 3/4" | | | | | |
| | 4 CF8 | 4 304SS | E ETFE | | | | 01 1" | | | | | |
| | 6 DI / CI | | K KYNAR | | | | 01.25 1-1/4" | | | | | |
| | | | | | | | 01.5 1-1/2" | | | | | |
| | | | | | | | 02 2" | | | | | |
| | | | | | | | 02.5 2-1/2" | | | | | |
| | | | | | | | 03 3" | | | | | |
| | | | | | | | 04 4" | | | | | |
| | | | | | | | 06 6" | | | | | |
| | | | | | | | 08 8" | | | | | |
| | | | | | | | 10 10" | | | | | |

Lined Swing Check Valve, Body DI + PFA Liner, Trim 304 + PFA Liner, Seat PTFE, Wafer ANSI Class 150# Size 6"

7LS-64A-W006

